



BEFORE



Above Teresa (left) felt the previous bathroom was bland and dated and didn't make the most of the generous space

Right The couple chose the Como bath from Victoria + Albert for its modern yet classic style. Tiling the floor and shower enclosure walls in the same Castiglione marble-effect tiles by New Image makes the space feel larger



FACT FILE

THE OWNERS

Gareth and Teresa Williams, who are both teachers

THE PROPERTY

A four-bedroom detached house built in the 1930s

THE LOCATION

Charmouth, Dorset

WHAT THEY SPENT

The couple have spent around £9,300 on their bathroom project

'We wanted a stylish yet affordable new look for our dated bathroom'

As part of a house renovation project, Teresa and Gareth Williams turned a poorly designed bathroom layout into a bright contemporary space

WORDS JANE BOWLES PHOTOGRAPHS COLIN POOLE



DESIGN TIP

White is a timeless colour for sanitaryware as it makes it easy to mix and match different elements to create your own unique look and take advantage of any bargain opportunities, from end-of-line items to vintage classics

When we relocated here from Essex, we decided to buy a house that was in need of renovation, knowing that we could buy a bigger property for our money,' says Teresa. 'We soon found the perfect house with stunning sea views, near Lyme Regis. It needed a lot of work throughout, including the bathroom.'

The décor was an uninspiring mix of 1980s wallpaper and tiling with a fitted carpet – and the bath was hidden behind a low brick wall. However, Teresa and her husband Gareth could see that its generously proportioned space with a large

window and high ceiling could be turned into a stylish bathroom.

'We visited the showrooms at local bathroom specialist Ocean Bathrooms, where we talked through our ideas with its head designer, Joe Muhl,' says Teresa. 'He took the room dimensions and devised a layout using computer-aided graphics.'

As the couple had extensive renovation work to do throughout the house, they set a strict budget of £10,000 for the bathroom project, which would include installation.

'We wanted a modern yet classic look, with clean lines, contemporary fittings and natural-style marble tiling,' says Teresa. 'Joe assured us he could create exactly what we wanted within our budget, so we decided

to go ahead and finalise the design and start choosing the fittings.'

To keep down the plumbing bill, Joe suggested leaving the existing pipework. He created a new look by relocating the fittings – the bath would be moved to where the old basin stood, with a walk-in shower in the bath's original position, so there would be no need for additional plumbing.

Teresa and Gareth were not entirely convinced, however, as Teresa explains: 'We thought a freestanding bath in the centre of the room would be perfect because of the large proportions of the space.'

Joe persuaded the couple that the contemporary bath-tub they had set their heart on would actually look better placed ▶



The stylish contemporary Duravit X-series console unit has plenty of storage space. The rectangular basin, also by Duravit, is from the Vero range



The splashback's Nero tiles are from Tilewise and make an almost exact match to the flooring



Water-saving fixtures and fittings from Hansgrohe were used to create an eco-friendly bathroom, including this Puravida 120 Baton hand-shower

'We had mirrored glass cut to fit the space above the basin instead of buying an expensive off-the-shelf option'

along one wall, with the taps in the centre.

'He was right,' Teresa admits. 'He had also come up with a great new layout that paved the way for a luxury wetroom-style shower along the facing wall. We gave the go-ahead for the fitting.'

The couple's new bathroom was installed by fitters who tackled the entire project from start to finish, including ripping out the old bathroom, laying the flooring, tiling the shower and decorating the walls.

'It certainly took the stress out of doing the decorating ourselves,' says Teresa.

Once the work was under way, the fitters advised them to have a slightly raised shower cubicle, rather than a flush walk-in option.

'They said it would keep down plumbing costs in the future as it would make it easier to access the plumbing,' Teresa explains.

As the couple were keen on creating an

eco-friendly bathroom, they chose an energy-saving Hansgrohe Ecostat shower for their wetroom-style enclosure and a water-saving Hansgrohe Puravida mixer tap for the basin opposite, which is housed above a large wooden-style vanity unit with deep drawers for extra storage.

With an eye to keeping costs down, they had a piece of mirrored glass cut to fit the space above the basin instead of buying a more expensive off-the-shelf option.

Teresa was thrilled when she sourced the marble tiles for the basin splashback from a supplier in Taunton.

'They're almost an exact match for the floor tiles that were supplied by Ocean Bathrooms,' she says. 'I do love our marble flooring – it's just like stepping into a luxurious spa room.'

Everything went according to plan until

the cold December weather kicked in just a few days before the couple's bathroom was due to be completed.

'Ocean's vans couldn't make it up our country lane, which was iced over, so the remaining equipment had to be brought to the house in wheelbarrows,' Teresa explains. 'Amazingly, our two-week bathroom re-fit was only a day over schedule – and all within budget too.'

Knowing that a house renovation would be a stressful experience, Teresa and Gareth are thrilled to retreat to their new bathroom.

'It's a wonderfully relaxing space where we can escape for a little "me time" amid all the upheaval,' says Teresa. 🏠

CONTACT

Designer: Joe Muhl, Ocean Bathrooms
01308 420011 Oceanbathrooms.com



ALTERNATIVES TO WETROOMS

Get a stylish wetroom look, without the complex installation and price tag, with these great options

PLANS

BEFORE

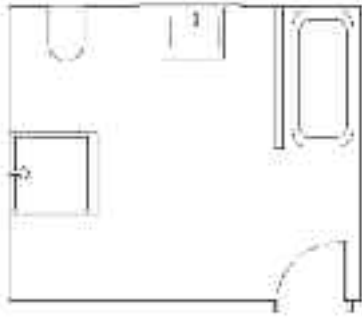

AFTER

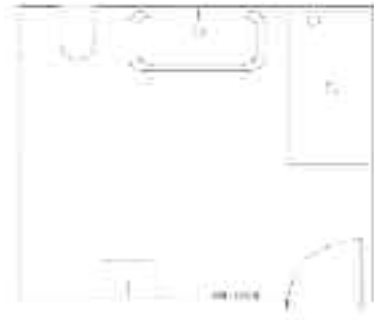

The shower has been relocated to the bath's original position, while the bath has been moved to the basin's old location, making better use of the space

COSTS

Design, labour and installation	£3,500
Fixtures and fittings	£4,801
Walls and flooring	£809
Furniture and accessories	£191

Fixtures and fittings: Victoria + Albert Como bath, £1,062; Hansgrohe bath mixer taps and hand-shower, £569; Hansgrohe shower, £288; Eau Zone shower tray, £372; Standard Monaco shower screen, £660; Duravit Vero basin, £251; Duravit vanity unit and console, £905; Hansgrohe basin mixer tap, £267; Duravit Starck 3 series WC, £214; Duravit Starck 3 series cistern, £124; Duravit Starck 3 series WC seat, £89, all supplied by Ocean Bathrooms

Walls and flooring: Matt emulsion in Brilliant White, £88, Dulux. New Image Castiglione floor and wall tiles, £576, supplied by Ocean Bathrooms. Nero wall tiles (small), £145, Tilewise

Accessories: Roman blind, £100, ABC Blinds. Premier flat towel warmer, £127, Radox Radiators. Towel rack, £40, Next Home

TOTAL £9,301



▲ Simple-style fittings

Create the perfect shower experience with a **Playtime Walk-through Shower Screen** with ceiling fixing, from £499 for a tempered glass screen measuring (H)200x(W)100cm, then team with a slimline **Shower Tray**, from £129 for a tray measuring (W)76x(L)90cm, both **Bathstore**

▼ Versatile size trays

An easy-to-fit choice for any shower and made from hardwearing acrylic capped resin stone, **Mira Flight Low Shower Trays** come in four different shapes and 27 sizes, with prices from £189.60 for a square (W)76x(L)76cm tray, **Mira Showers**



▲ Designer-look shower

Make a style statement with the **Embrace Corner Wetroom** panel with designer motif; prices from £466.77 for a panel measuring (H)190x(W)90cm. The **Room Infinity Shower Tray**, available in rectangular and quadrant shapes, costs from £495.39 for a quadrant tray, (W)90x(L)90cm, both **Roman Showers**

Choose a low-level shower tray

David Osborne, MD of Roman Showers, says:



'If you're wary about installing a wetroom because of the upheaval and cost of making a bathroom watertight, a low-level shower tray is a great alternative. If you choose a solid surface tray, you can install it down to your floor joists, so it will be flush with the tiles. Once it's fitted, consider using a wetroom panel to define the area. If you like enclosed showering, choose a walk-in shower enclosure as it's more secluded. You can also fit an enclosed shower to a low-level tray to get the wetroom look in a sealed area. Whichever you choose, get quotes for installation.'

COMPILED BY LUCY SMITH